



XenonSmart Wi-Fi Outlet User Manual



US

The devices are not intended for use in location where the temperature may be less than actual room conditions, such as unheated warehouses or garages.

Works with Amazon Alexa

Ver :PP1704XN -A

Compatible with any smart phone, including Android devices, iPod, iPhone, iPad running Android or iOS.

Download and install the Xenon Smart app for eighter iOS or Android.



Android



iOS

Once downloaded, the app will ask you to register your device. Enter your cell phone number or email and select country and you will receive a text with the registration code.



Input the Registration Code you received via text and proceed to login.

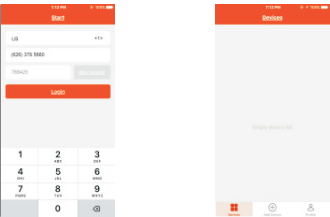

Adding a New Device

- * Press and hold the On/Off smart button for 6 seconds until it flashes.
- * Open app and click “+” to add device.
- * Select WiFi network>Conect an click
- * Once connected the app will prompt the connection> click OK

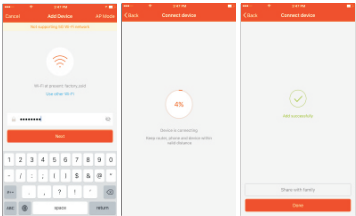

AP Mode

- * Press “+” in the main menu
- * Click “AP Mode” and press Next Step in Add Device
- * Select WiFi and input WiFi password, press Next in Set up Wi-Fi for device
- * Press Connect now
- * Go to WLAN setting in your cell phone and select the “SmartLifeXXXXX” for your WiFi
- * Go back to app and press “Connect” Device name is “SmartLifeXXXXX”, password is 888888888 (9*8)
- * Confirm Device

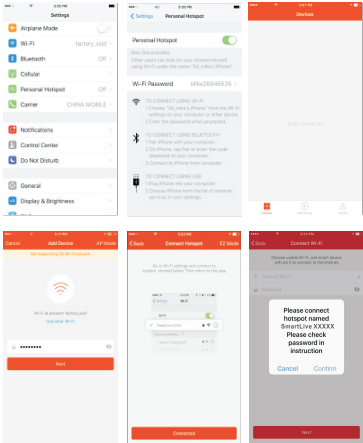

Turn On/Off via app, the almighty Power Button

- * Click “xenonsmart” in the main menu;
- * Press Power Button to turn plug On/Off.

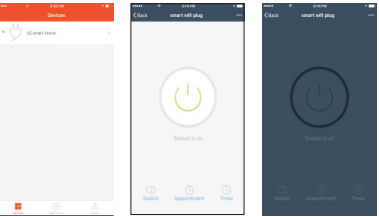

Device Functions: Basic Controls and Usage

- * Main Menu
- * Select Switch / Appointment of Timer setting
- Appointment: Make sure your friends have access when they need it.
- * Click the “Appointment” function to set the plug to a timer of your choice.
- * Click Confirm Setting or hit back to Exit Timer: Control your home or office remotely
- * Click the “Timer” function to set time schedule and press “Add Timer”
- * Set Time/Date for your desired time schedule
- * Click “Confirm” to save timer setting or hit back to exit.

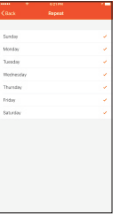
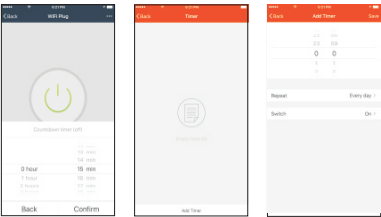

Profile: Username and info setup

- * Click the Profile “function” in the main menu to open;
- * Device Sharing and Message Center;

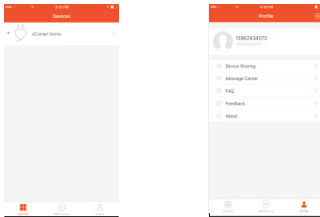

Device Sharing Control of the Smart Plug Device

- * Select “Device Sharing” in Profile and press “Add Sharing”;
- * Input the cell phone number/email of the device you want to share control with after click “Share With New Member”;
- * Add Nickname or Username
- * press Control once selected
- * Device will automatically appear in “Devices Sharing” once added.

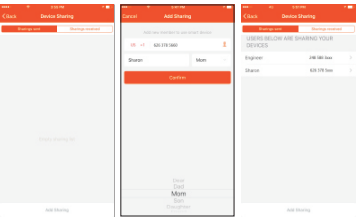

1 2

3 4

5 6

7